



Thursday 19<sup>th</sup> August 2021

Dear Parents and Carers

I hope this letter finds you and your family well and in the midst of a very enjoyable holiday. During the break, we have taken some time to review the latest guidance from the DfE as well as consult with colleagues from our trust to make plans for our return next week that will hopefully have a sense of normality for us all! Please find details about this below.

**What will happen at the start and end of day?**

EYFS and KS1: 8.50am to 3.05pm (although doors will still be open from 8.35am if you have older siblings)  
KS2: 8.35am to 3.10pm

Children will enter and exit through their classroom doors which is the same as 2020-2021. A map of this is attached with this letter. There will be staff around to help parents and children so please do ask one of us if you are unsure.

**What will happen at break times and lunchtimes?**

Children will have a 15 minute break in the morning. These will be split across the key stages at slightly different times to facilitate the timings of different lessons during the morning. Lunchtimes will be held at the following times:

Years 1 to 6	12.00pm to 1.00pm
Year R	12.30pm to 1.30pm

There will be no separation on the playground of children from different year groups and Year 6 will return to the main playground for the majority of the time.

**What will happen with assemblies?**

There will be 2 'live' assemblies a week. These will be on a Monday and Friday first thing in the morning. The other days' assemblies will either be delivered virtually or by the teachers in the classroom to allow more flexibility with timings during the day.

**What about resources?**

There is no expectation that resources must only be used by an individual or within a 'bubble' anymore. Children may now bring in treats for their class on their birthday if they wish to. Please note that we are a nut-free school as we have several members of our community with serious allergies.

**What about handwashing?**

This will remain the same as last year and will still take priority as a key measure of control.

**Should my child wear their school uniform?**

Yes- children are now expected to return to school in full uniform.



**Swallowdale  
Primary School**

**Dalby Road, Melton Mowbray, Leicestershire, LE13 0BJ**

**Telephone: 01664 565456**

**Email: [office@swallowdale.bepschools.org](mailto:office@swallowdale.bepschools.org)**

**Website: [www.swallowdale.bepschools.org](http://www.swallowdale.bepschools.org)**

**Headteacher: Mrs S Harries**



### **What happens if your child displays symptoms?**

If your child displays any of the symptoms, they must isolate and have a PCR test to confirm if they are positive or negative. If the result is positive, track and trace will be in touch with you directly for any contact tracing. School will no longer close any bubbles. If your child does have a positive result and needs to isolate, please contact school by either phoning the office during term time or by using the form on the website. If the result is negative, your child may return to school once they feel well enough.

We will continue to review these systems as the start of term begins and in line with any changes to DfE guidance. We will be completing our contingency plan should we be asked to return to implanting a bubble system again and will update you should this happen.

I look forward to welcoming you all back to school on Wednesday 25<sup>th</sup> August 2021. In the meantime, enjoy the remaining days of your holiday.

Kind regards

Mrs Samantha Harries  
Headteacher



**Swallowdale  
Primary School**

Dalby Road, Melton Mowbray, Leicestershire, LE13 0BJ

Telephone: 01664 565456

Email: [office@swallowdale.bepschools.org](mailto:office@swallowdale.bepschools.org)

Website: [www.swallowdale.bepschools.org](http://www.swallowdale.bepschools.org)

Headteacher: Mrs S Harries



DROP-OFF POINTS in the morning

ENTRANCE GATES HERE

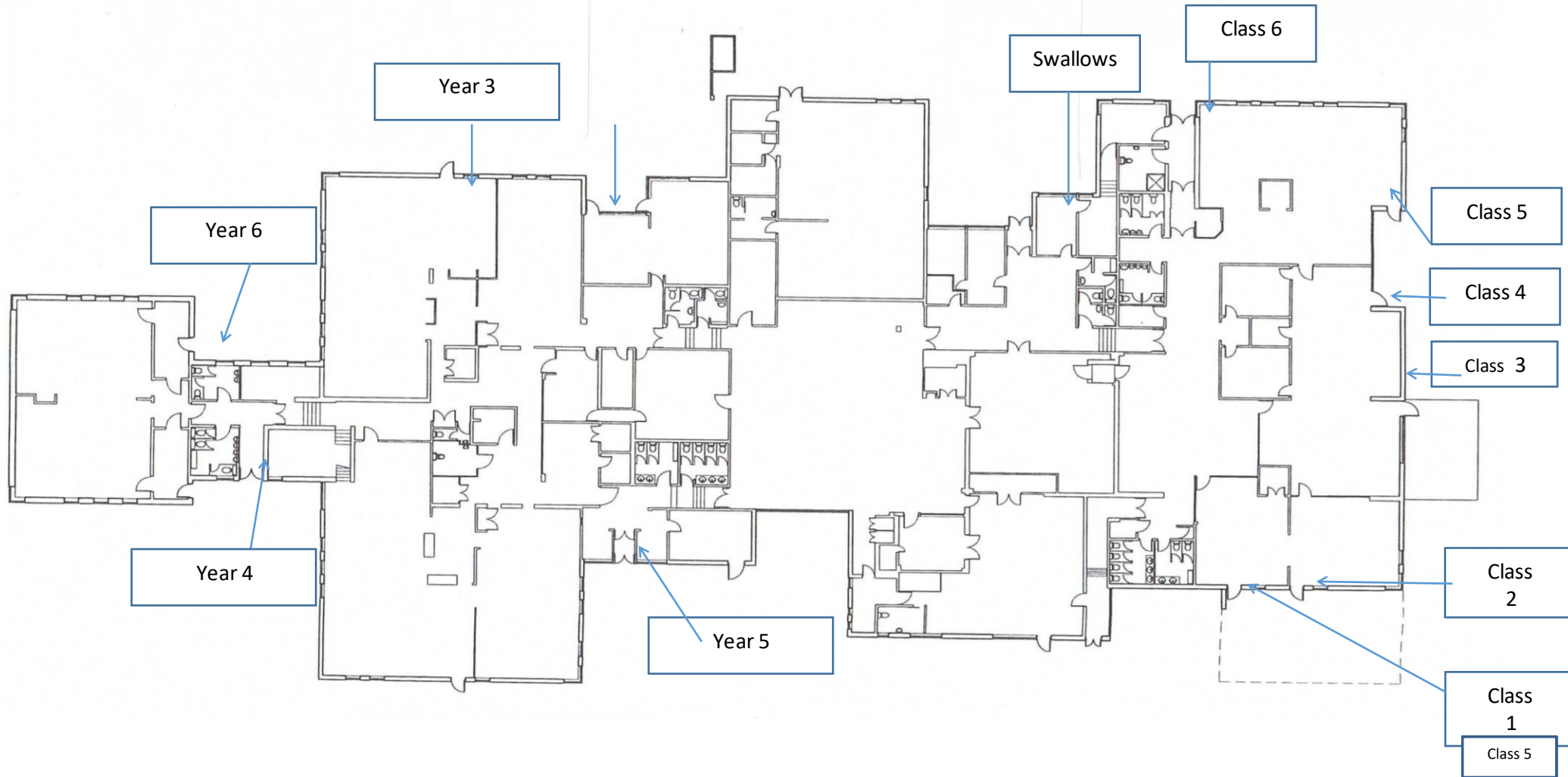



**Swallowdale  
Primary School**

Dalby Road, Melton Mowbray, Leicestershire, LE13 0BJ

Telephone: 01664 565456

Email: [office@swallowdale.bepschools.org](mailto:office@swallowdale.bepschools.org)

Website: [www.swallowdale.bepschools.org](http://www.swallowdale.bepschools.org)

Headteacher: Mrs S Harries



COLLECTION POINTS

